

MATTHEW JAMES

Residential Sales • Lettings • Management



St. Marys Flats Doric Way, London, NW1 1LB

Asking Price £469,950

We offer for sale a fourth floor three bedroom flat with lift access requiring decorating and updating in parts. Located centrally and close to London Euston and St Pancras International Stations, whilst to the west and within walking distance are the wide open green spaces of Regents Park, Camden Town with its famous bustling market is a short walk north and well located for access to both Central and the West End of London with its array of attractions. Available for sale chain free. New 250 Year Lease. Mixed Tenure Block.

Fourth Floor
Lift and stair access.

Hallway

Living Room



Bedroom Two



Bedroom Three



Kitchen



Bathroom/W.C.



Bedroom One



Additional Information



Camden Council Tax Band D
New 250 Year Lease
Service Charges - £1033
Ground Rent - Zero
Mixed Tenure Housing

Floor Plan

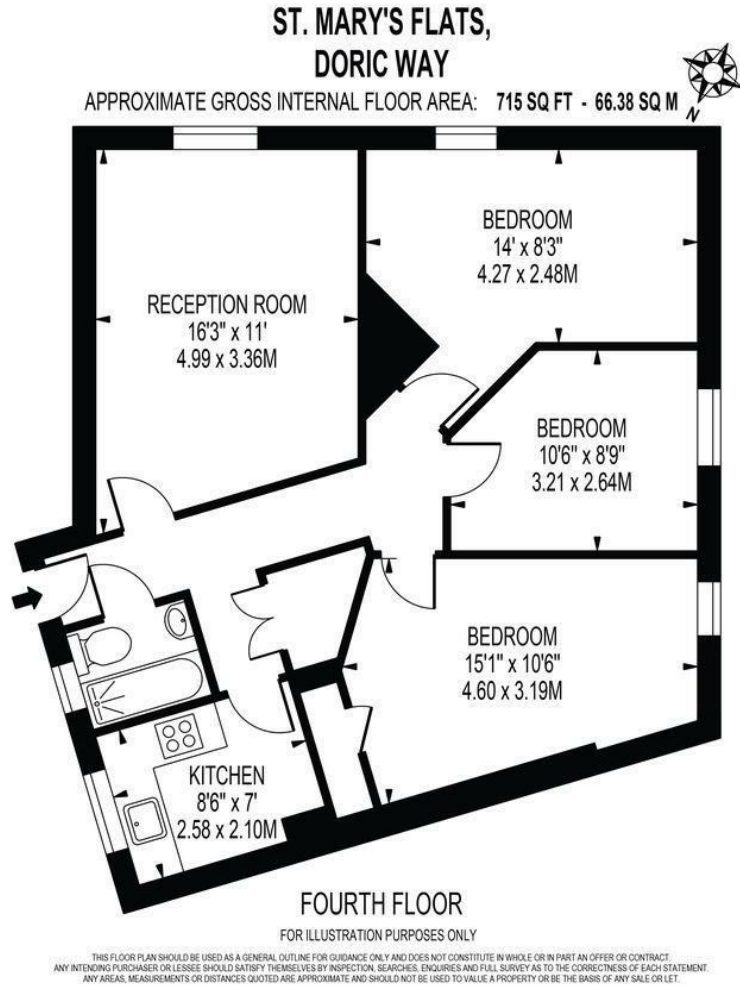

Area Map

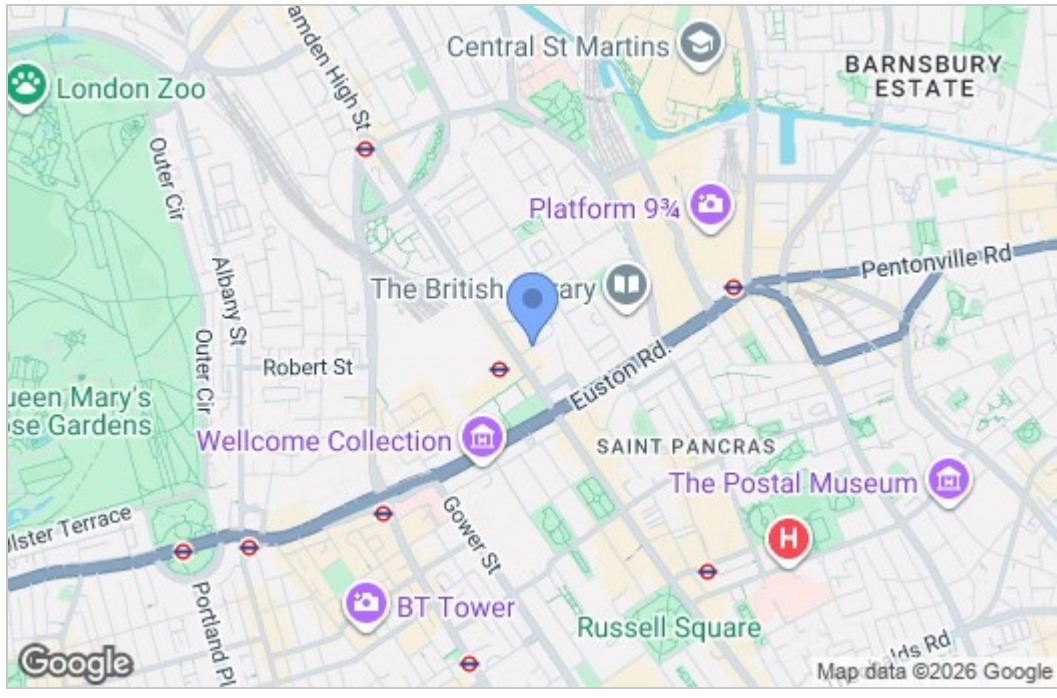

Energy Efficiency Graph

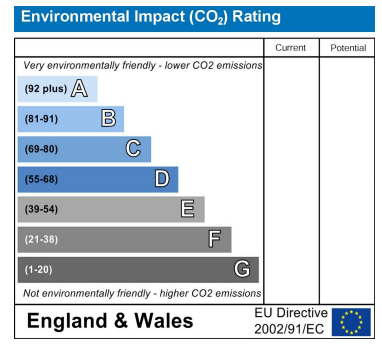
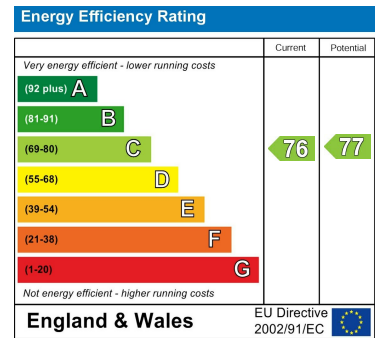

These particulars, whilst believed to be accurate are set out as a general outline only for guidance and do not constitute any part of an offer or contract. Intending purchasers should not rely on them as statements of representation of fact, but must satisfy themselves by inspection or otherwise as to their accuracy. No person in this firm's employment has the authority to make or give any representation or warranty in respect of the property.